

www.oemmespa.com

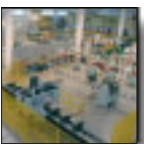

**AS**

**THERMAL BREAK PROFILE ASSEMBLY EQUIPMENTS**

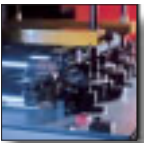

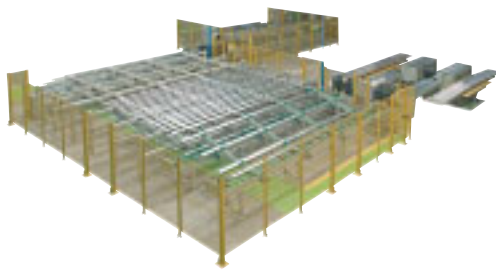

OEMME s.p.a. thermal break profiles assembly equipments consist of a group of machines for working thermal insulated profiles, obtained by the joining of the inner and outer aluminium shells of the profile through insertion of one or more plastic bars and further crashing of the edges of the profile to get a unique profile.

Thermal break profile assembly equipments are of modular construction. They consist of min. 3 machines but they can be designed and realized according to the customer's demands of place, productivity and costs.

The automation ratio and the disposition of the machines are the main elements according to which OEMME s.p.a. plans customized equipments for an optimal service which meet the demands of extruders with both small and large processing equipments.

## Every machine is equipped with:

- Installation, operation and maintenance manual
- CE conformity declaration
- Metal plate indicating code, registration number and production year
- Wooden crate with stiff base, generally fixed to the machine
- Electric and pneumatic diagrams
- Spare parts list
- Service spanners

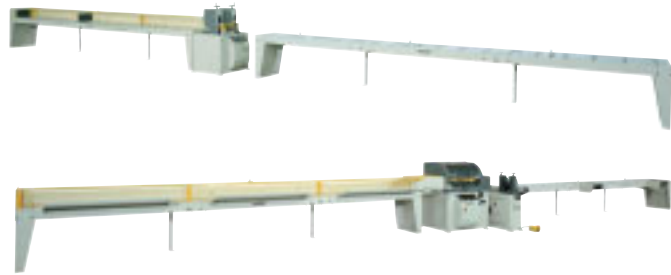

## Concept of thermal break profile assembly

The process to perform thermal break profiles consists of three phases:

### 1<sup>st</sup> KNURLING OPERATION phase

Knurling of the plastic bar grooves.

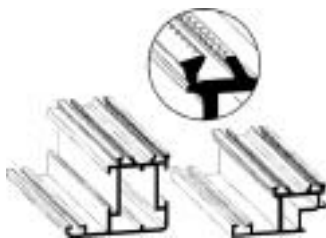

### 2<sup>nd</sup> BAR INSERTION phase

Insertion of the plastic bars in the grooves, previously knurled, so that the inner and outer aluminium shells of the profile are connected.

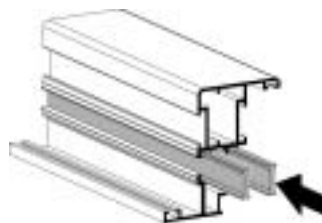

### 3<sup>rd</sup> ASSEMBLY phase

Crashing of the edges of the bar grooves by rolling to get a unique monolithic profile.

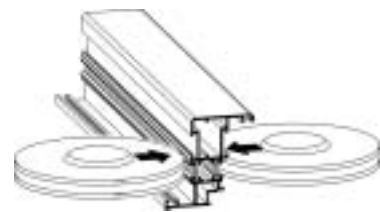

## Lay-out

Thanks to decades of experience in the field of window and door frames, OEMME s.p.a. tailors thermal break assembly equipments to fit any customer's requirements. OEMME s.p.a. plans the equipments according to the requested productivity of bars, the available place and any particular customer's demand for an optimal lay-out without ever overlooking the safety of the operator.

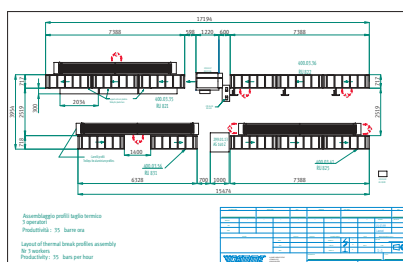

PRODUCTIVITY of OEMME s.p.a. thermal break assembly equipment can vary from min. 35 to max 100 bars/hour.

## Grip-test

When the assembly operation is over, a grip test is carried out on a profile sample 100 mm long. This test is required to get the product certification.

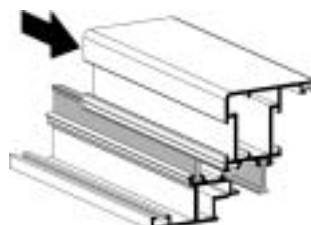

## Export Department

Via F. L. Ferrari, 23  
44100 FERRARA - ITALY  
Tel. +39.0532.777418  
Fax +39.0532.777477  
sales@oemmespa.com

## Sales office Italy

Via Cavallotti, 16  
42010 REGGIO EMILIA - ITALY  
Tel. 0522.271275  
Fax 0522.923879  
vendite@oemmespa.com

## Head office and Production

Via F. L. Ferrari, 23  
44100 FERRARA - ITALY  
Tel. 0532.777411  
Fax 0532.777444  
info@oemmespa.com